*Figure 1: Model 6243-J3 or 6679-J3 Lever Gun***DESCRIPTION**

Models 6243-J3 and 6679-J3 heavy-duty, lever guns are designed to handle fibrous, heavy- or light-bodied lubricants. Both models are spring primed and equipped with a special loader fitting, a check valve and an extra long handle for maximum leverage.

These units can be loaded with a 14 oz. lubricant cartridge or with 24 oz. of bulk grease by either the suction-filling method, or by a loader pump.

SPECIFICATIONS

Capacity 24 oz. bulk or 14 oz. cartridge

Pressure Capabilities (Model 6243-J3) 10,000 PSI
(Model 6679-J3) 5000 PSI

Delivery (Model 6243-J3) 1 oz./20 strokes
(Model 6679-J3) 1 oz./10 strokes

Gun Outlet 1/4 N.P.T.F.

ACCESSORIES

For a list of accessories, see the Alemite Lubrication Supplies and Accessories Catalog.

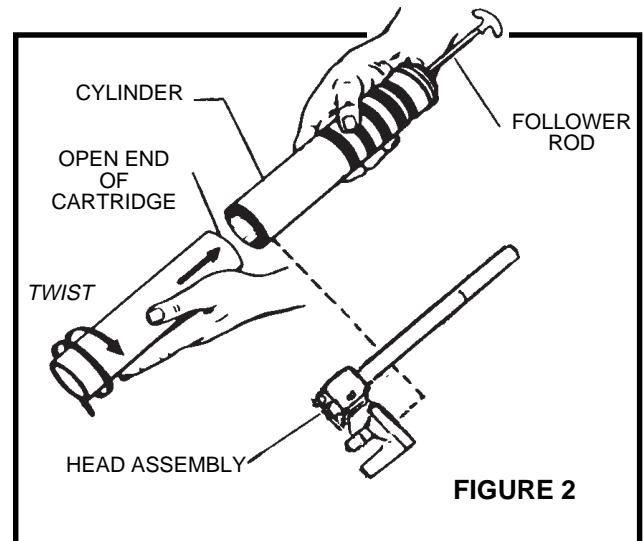
**FIGURE 2****Alemite Corporation**

167 Roweland Drive, Johnson City, Tennessee 37601

PREPARING FOR OPERATION

Attach extension (not supplied) or hose assembly (not supplied) with appropriate type coupler to unit and prepare for operation by filling lever gun as follows:

LOADING

A. CARTRIDGE LOADING:

(Figure 2):

1. Separate head assembly from cylinder.
2. Pull follower rod out and engage first groove on follower rod with offset hole in end cap (Figure 5).
3. Remove cap from end of cartridge and insert opened end into cylinder.
4. Remove seal from other end of cartridge.
5. Screw head assembly onto cylinder.
6. Release follower rod from end cap offset hole and push into cylinder (Figure 5).

B. SUCTION FILLING:

(Figure 3):

ATTENTION: If an extremely heavy lubricant is used, it may be necessary to pack lubricant by hand, using a clean paddle or putty knife, rather than employing the suction method. These two means of filling should be done with follower rod engaged in offset hole in end cap. Follower rod should show both grooves to enable cylinder to be filled completely.

When using medium weight lubricants, perform the steps following:

1. Remove head assembly from cylinder.
2. Insert open end of cylinder two inches below surface of lubricant.
3. Slowly pull back follower rod, drawing in lubricant until second groove in follower rod can be engaged with the offset hole in end cap.
4. Screw head assembly onto cylinder.
5. Release follower rod from end cap offset hole and push into cylinder.

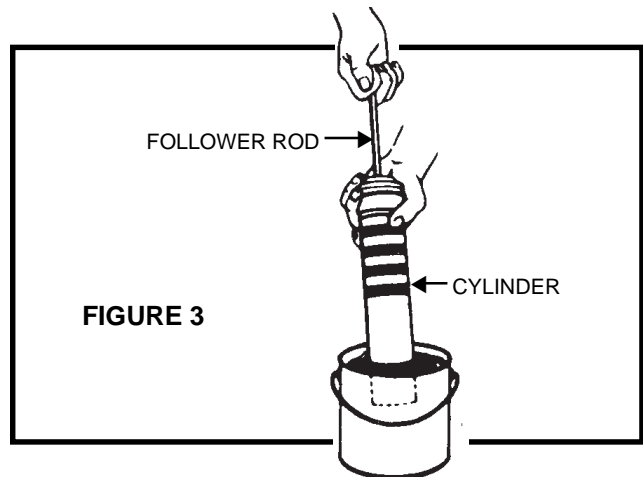

FIGURE 3

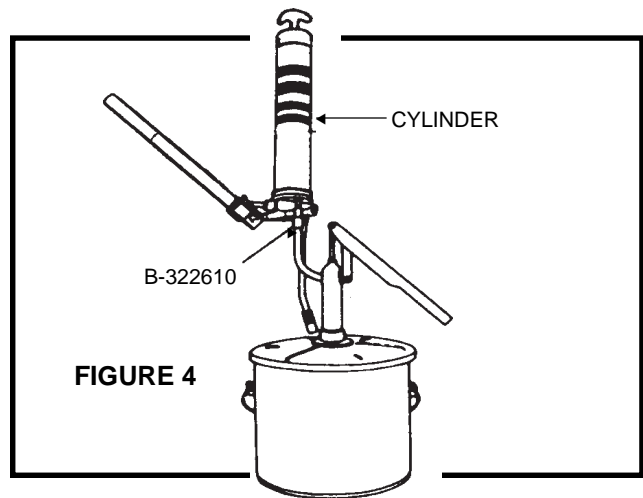

FIGURE 4

C. BULK LOADING (USING LOADER PUMP ONLY): (Figure 4)



These guns are equipped with a bulk loader fitting for use with hand powered, low pressure loader pumps. Modification to substitute a high pressure grease fitting so that air or electric powered pumps can be used for loading can result in damage to the gun and serious personal injury. This will also void the warranty.

1. Wipe loader fitting B-322610 (Figure 6) clean of any material.
2. Pull back and rotate follower rod to engage locking key in "twist-lock" slot on follower backup plate 337059.
3. Insert loader fitting into valve of loader pump.
4. Operate loader pump to fill cylinder until second groove on follower rod is exposed (Figure 6).
5. Disengage "twist-lock" and push follower rod into cylinder.

OPERATION

1. Clean any dirt or grease from the fitting to be lubricated.
2. Attach the coupling end of the extension or hose assembly to the lubrication fitting.
3. Operate the lever until desired amount of lubricant is dispensed.

CAUTION: These guns can develop up to 10,000 psi pressure. Excessive lubrication may damage equipment.

IMPORTANT: To ensure long service, and efficient operation of coupler, do not yank it off fitting.

4. Remove coupler by tilting sideways and rolling off of fitting.

MAINTENANCE

A. Packing nut 52315 or 43395 should be checked occasionally for snug fit to prevent leakage. If leakage at packing nut persists after nut has been fully tightened, check piston 52329 or 303161 for damage and/or replace packings 52314 or 43394 (Figure 6).

B. Common causes of gun malfunction are air pockets, malfunctioning check valves, and defective lubricant cartridges. If gun fails to pump lubricant, follow these steps:

1. Loosen head assembly from cylinder.
2. Pull out follower rod and engage locking key in "twist-lock" slot on follower backup plate 337059 (Figure 5).
3. Slowly push follower inward, toward head to eliminate air pockets.
4. Tighten head assembly to cylinder.
5. If pumping on lever now sends lubricant through coupler, disengage locking key from "twist-lock" slot and push follower rod into container.
6. If lubricant still does not pump out, sharply tap gun head on a block of wood several times.

CAUTION: Do not tap gun head on hard surfaces such as metal or concrete.

7. Pump lever until lubricant appears at coupler.

NOTE: If using lubricant cartridge, and problem persists after performing steps 1 through 7, discard defective cartridge and replace with a new one. If cartridge has an irregular inner surface, the steps above probably will not force gun to pump lubricant.

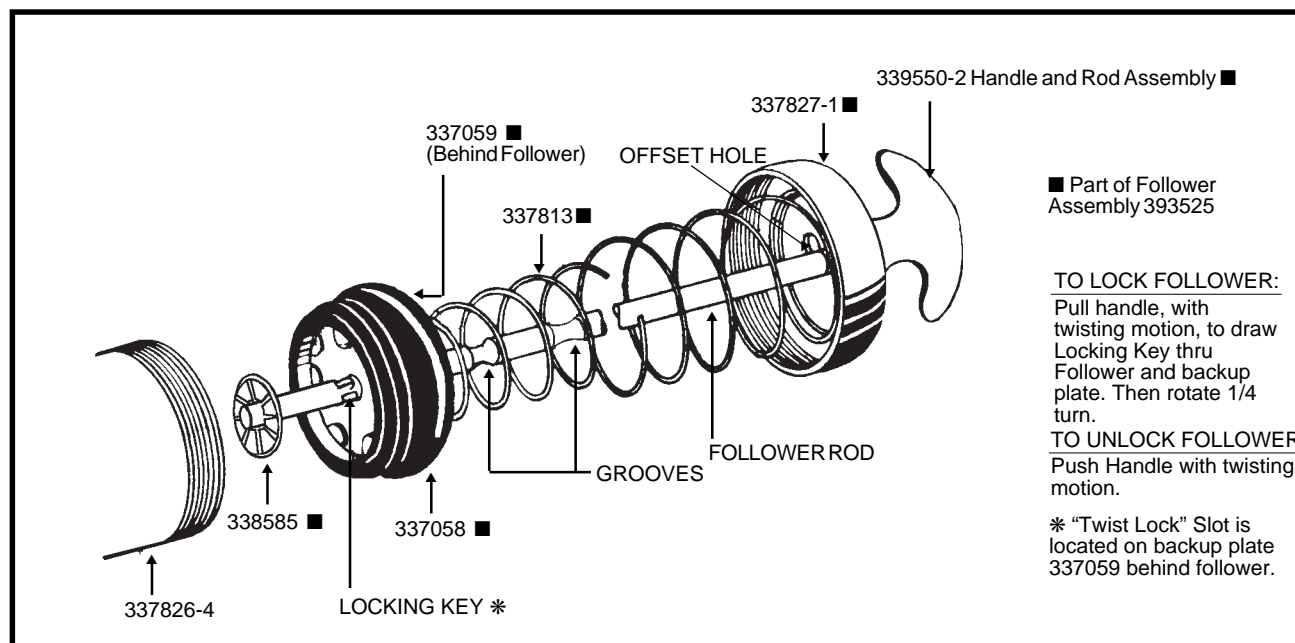

Figure 5: Cylinder Configuration with Locking and Unlocking Instructions

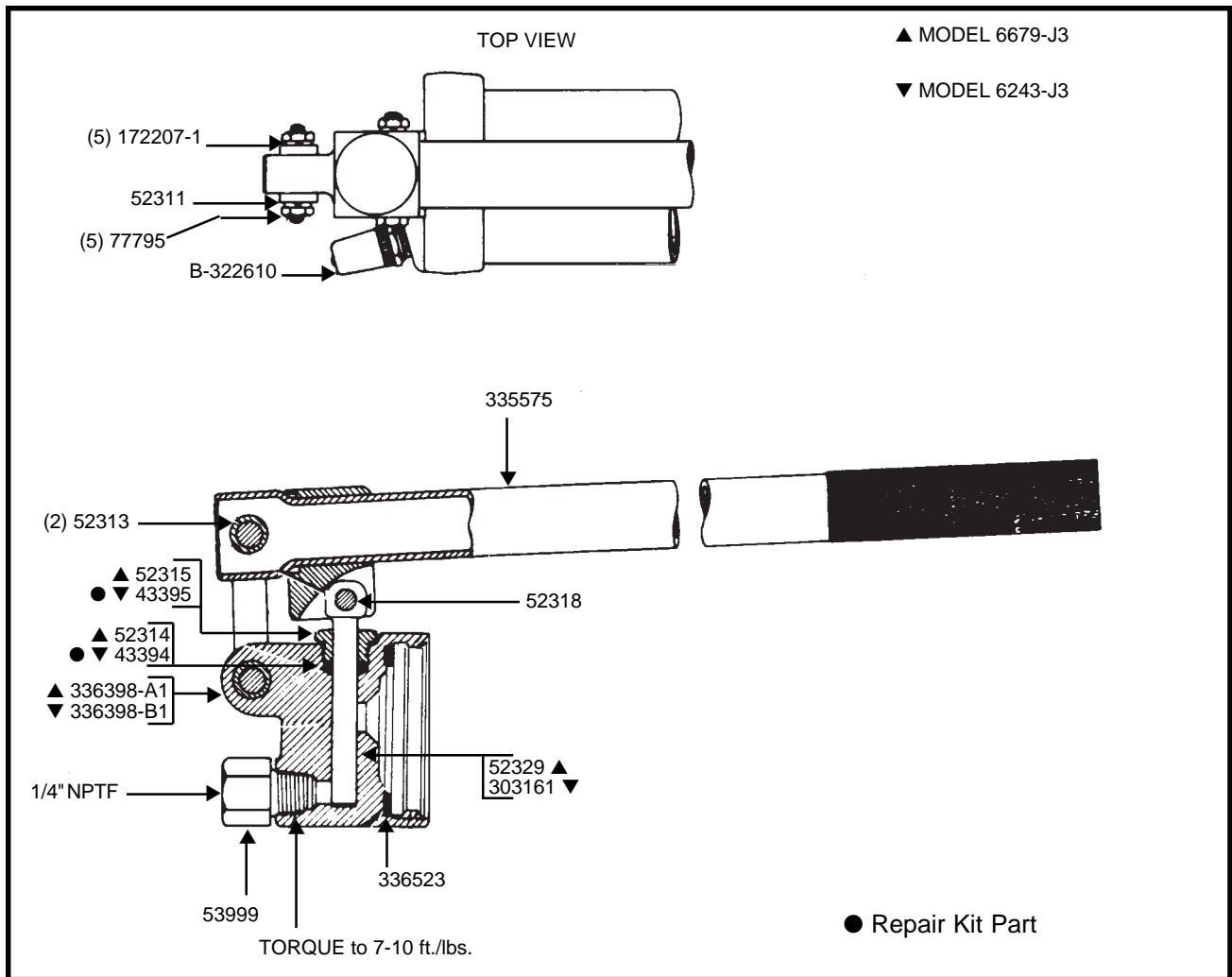

Figure 6: Head Assembly for Models 6243-J3 and 6679-J3 Guns

Minor Repair Kits

393604 For Cylinder Assembly of 6243-J3 & 6679-J3 Grease Guns		
Part No.	Description	Qty
337058 Follower	5
337059 Backup Plate	2
338585 Pushnut	5

393525 For Cylinder Assembly of 6243-J3 Guns		
Part No.	Description	Qty
337058 Follower	1
337059 Backup Plate	1
337813 Spring	1
337827-1 Cap	1
338585 Pushnut	1
339550-2 Handle and Rod Assembly	1

393610 For Cylinder Head of 6243-J3 Guns		
Part No.	Description	Qty
43394 Jewett-Ring Packing	1
43395 Packing Screw	1

PARTS LIST - Models 6243-J3 and 6679-J3 Lever Guns		
Part No.	Description	Qty
53999	Check-Valve Assembly	1
B-322610	Loader Fitting	1
* + 337581	Head Assembly (6243-J3)	1
* + 337582	Head Assembly (6679-J3)	1
* + 338587-B1	Cylinder Assembly	1
	+ Not available as a separate purchased part	
	* See separate parts list	

PARTS LIST — Head Assemblies 337581 and 337582		
Part No.	Description	Qty
● 43394	Jewett-Ring Packing (Model 6243-J3)	1
+ ● 43395	Packing Screw (Model 6243-J3)	1
52311	Link, 2-15/32" Long	2
52313	Link Pin, 1-13/64" Long	2
52314	Ring Packing (Model 6679-J3)	1
52315	Packing Screw (Model 6679-J3)	1
52318	Piston Pin, 1-11/32" Long	1
52329	Piston (Model 6679-J3)	1
+ 77795	Hex Nut, 1/4-20	5
+ 172207-1	Helical-Spring Lockwasher, 1/4"	5
303161	Piston (Model 6243-J3)	1
+ 335575	Lever and Bushing	1
336398-A1	Head and Bushing Assembly (6679-J3)	1
336398-B1	Head and Bushing Assembly (6243-J3)	1
336523	Gasket, 1-15/16" I.D.	1
	● Repair Kit Part	
	+ Not available as a separate purchased part	

PARTS LIST - Cylinder Assembly 338587-B1		
Part No.	Description	Qty
● + 337058	Follower	1
● + 337059	Backup Plate	1
● 337813	Spring	1
337826-4	Cylinder (zinc plated)	1
● + 337827-1	Cap (zinc plated)	1
● + 338585	Pushnut	1
● + 339550-2	Handle and Rod Assembly	1
	● Repair Kit Part	
	+ Not available as a separate purchased part	

NOTE: The parts listed in this instruction sheet are for reference identification in the instructions and illustrations. Some of them are not available as separate parts and these are noted in the parts list. Standard items such as nuts, bolts, etc. should be purchased at a hardware store. Refer to the current parts price list and bulletins before ordering parts, and always give the part number, quantity, description and model where used when ordering parts. Parts availability and prices are subject to change without notice.

PARTS CHANGES SINCE LAST PRINTING
Changed Handle and Rod Assembly to 339550-2