

DESCRIPTION

Utility pump Model 7531-B4 is of the hand-operated, lever-action type. It is designed to accommodate a 12.5 kg container.

Application of this unit eliminates hand and paddle filling methods, thus keeping lubricant clean and free of any contamination when being applied.

The high-pressure pump provides ample pressure to lubricate close-fitted bearings. Lubricant delivery is one ounce (28.4 gms) per five strokes. The dynamic primer aids priming in cold weather and enables the pump to handle heavier greases more readily. All pressure gun lubricants can be used. The follower plate prevents any channeling of lubricant.

The unit is equipped with a cover, follower plate, six foot (1.8 m) lubricant hose, and hydraulic coupler. The coupler provides a quick, leak-proof contact with the hydraulic fitting and allows a wide sealing angle connection.

SPECIFICATIONS

Pump Delivery 1 oz. (28.4 gms) per 5 strokes
Pressure Developed 3500 psi (241.4 Bar)
Finish Maroon baked enamel
cover with other parts bright zinc

ASSEMBLY

To assemble the pump, proceed as follows using Figures 2, 3 and 4:

1. Install and align pump mechanism 328232-2 onto the top of cover 339153.
2. Position plate 339152 to the inside of the cover. Align the bolt holes.
3. Secure all components with cap screws 77787 and hex nuts 77650. Tighten securely.
4. Align link 328253-1 with holes in stud 338389 and secure with pin 324749 and two cotter pins 43651.

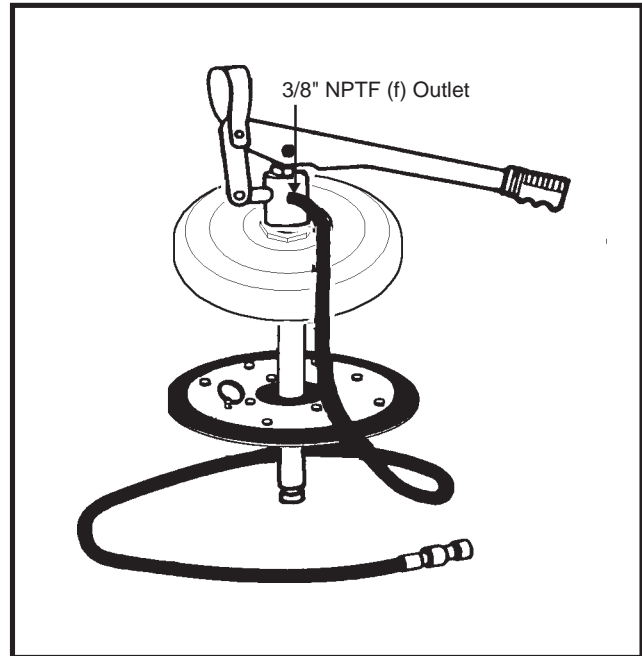

Figure 1 Pump Model 7531-B4

5. Align lever 314552 with pin hole in piston rod and secure with nut 77650, screw 170699, and lockwashers 79272.

6. Align link 328253-1 and handle 318414 with hole in lever 314552 and fasten with clevis pin 317245, and one cotter pin 43651.

INSTALLATION

To install pump, use Figures 2, 3, and 4 as reference and proceed as follows:

1. Place follower plate 338991 on lubricant surface in lubricant pail and press down until lubricant is forced into center opening of follower. This will remove any air pockets.
2. Insert pump tube assembly through the center opening of the follower plate. Secure cover to container with thumb screws 48018.
3. Screw five-foot (1.5 m) lubricant hose with hydraulic coupler into 3/8" lubricant-outlet check valve 317210.

OPERATION

To operate pump, proceed as follows using **Figure 2**:

1. Connect hydraulic coupler 308730-A with lubricant hose assembly 317853-5 to fitting.

CAUTION: Do not point dispensing device at oneself or any other person; accidental discharge of pressure will result in serious injury.

2. Work lever 314552 up and down until fluid emits from hydraulic coupler and lubricates fitting.

MAINTENANCE

Do the following periodically:

1. Check for sufficient lubricant in container.

2. Inspect lubricant hose and coupler assembly.

3. Wipe hydraulic coupler clean of any lubricant after every use.

4. Flush pump clean with appropriate solvent to dislodge any foreign material or excess lubricant.

DISASSEMBLY

If pump fails to deliver lubricant or function properly proceed in following sequence using **Figures 2, 3** and **4**.

1. Loosen thumb screws 48018 that secure cover assembly 339153 to the container.

2. Unthread nut 77650, screw 170699, lockwashers 79272, and remove lever 314552 from pump assembly.

3. Unthread tube assembly 317206-5 from body assembly 328233 and remove gasket 53776.

4. Unthread nut 45569 and cup 317201 from rod 317202. Unthread rod from plunger 317204-5.

5. Remove plunger 317204-5 and stop bar 317205-5.

6. Unthread bushing 328236 from body assembly 328233 and remove back-up ring 171017-12, "O" ring 171000-12 and gasket 328237.

7. Clean parts and inspect for damage or wear.

8. Replace any worn or damaged parts.

IMPORTANT: Damaged or worn parts are a potential danger to person and property. Do not reuse damaged or worn parts.

REASSEMBLY

Observe the following notes, then reassemble unit by reversing disassembly steps 1 through 6.

NOTE: Apply Loctite No. 222 on mating threads between rod 317202 and plunger 317204-5. Allow Loctite to cure 1-2 hours before further handling assembly.

Using SAE No. 10 motor oil, lubricate "O" ring 171000-12 and valve 317203 before reassembly.

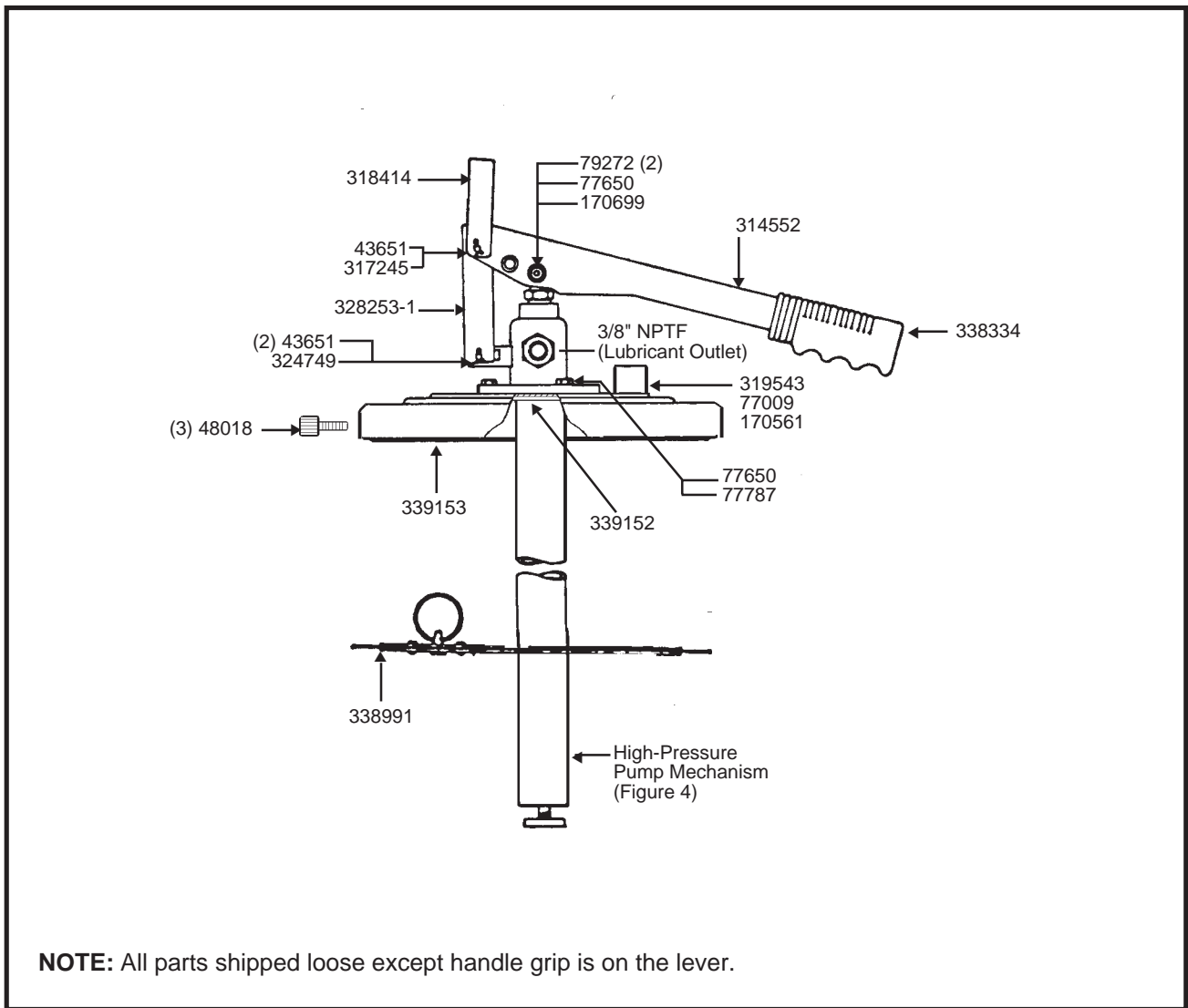

Figure 2 Components of Model 7531-B4 H.P. Utility Pump

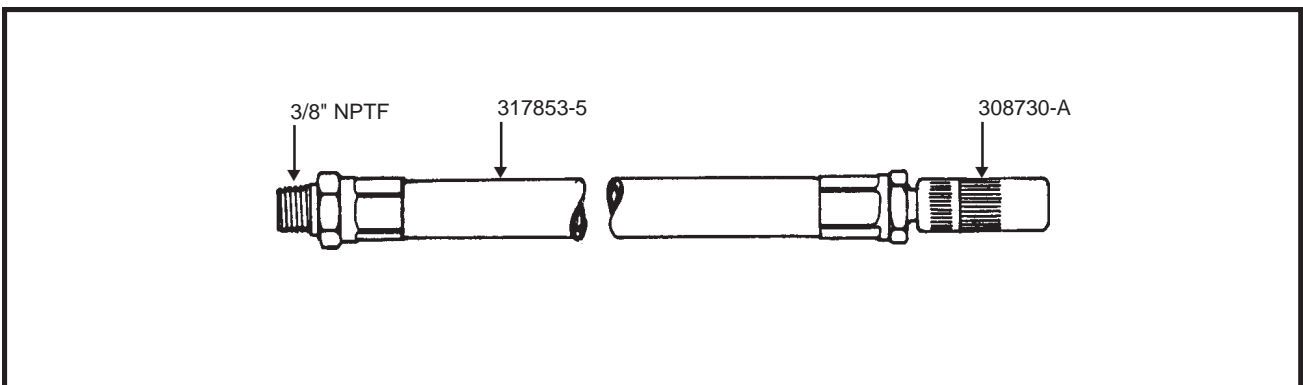

Figure 3 Model 322434 Hose and Coupler Assembly

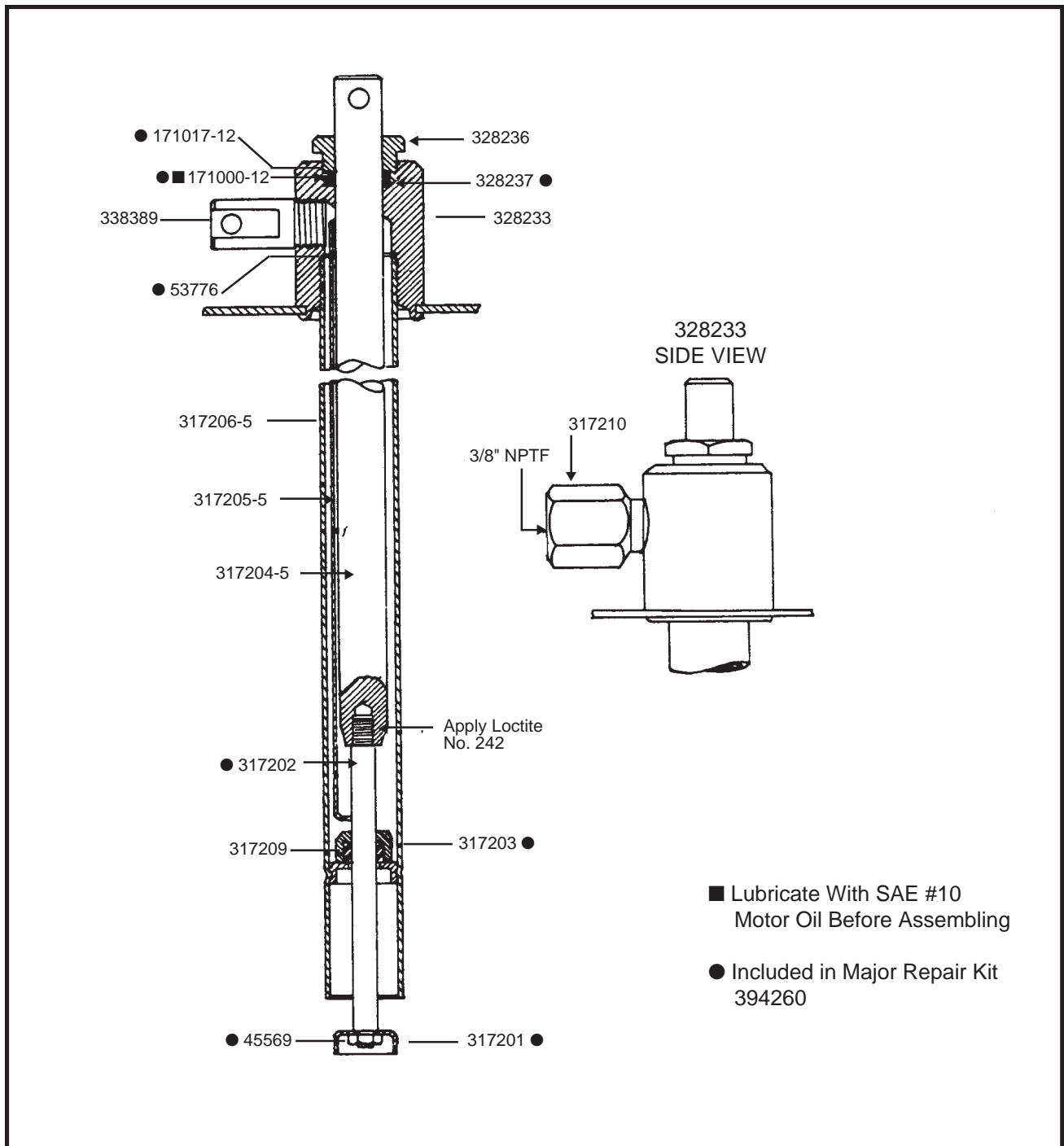

Figure 4: Components of High-Pressure Pump Assembly

Major Repair Kit

394260 High-Pressure Pump Mechanism Kit for Model 7531-B4 (Figure 4)

Part No.	Description	Qty.
45569	Hex Nut, 10-32	1
53776	Aluminum Gasket, 49/64" I.D. x 15/16" O.D.	1
171000-12	"O" Ring, 5/8" I.D. x 13/16" O.D.	1
171017-12	Back-up Ring, 13/16" O.D.	1
317201	Cup	1
317202	Rod	1
317203	Valve	1
328237	Aluminum Gasket, 1/2" I.D. x 15/16" O.D.	1

PARTS LIST - High-Pressure Utility Pump for Model 7531-B4 (Figure 2)

Part No.	Description	Qty.
+	43651 Cotter Pin, 1/16" X 1/2" long	3
	48018 Screw, Thumb	3
	77009 Washer, Lock, Internal Tooth	1
	77650 Hex Nut, 1/4-20	4
	77787 Hex-Head Cap Screw, 1/4-20 x 5/8"	3
+	79272 Lockwasher, External-Tooth, 1/4"	2
	170561 Screw	1
+	170699 Screw (Special), 1/4-20 UNC	1
+	314552 Lever	1
+	317245 Clevis Pin, 1/4" x 1-3/8" long	1
	318414 Handle	1
	319543 Bushing	1
*	322434 Hose and Coupler Assembly	1
	324749 Pin, 1/4" dia. x 31/32" long	1
	338991 Follower-Plate Assembly	1
+	328253-1 Link, 4-1/8" long	1
	338334 Handle Grip	1
+	339152 Plate	1
+	339153 Cover	1
	* + High-Pressure Pump Mechanism	1

* See separate parts list
+ Not available as a separate purchased part

PARTS LIST - Model 322434 Hose and Coupler Assembly for Model 7531-B4 (Figure 3)

Part No.	Description	Qty.
317853-5	Hose Assembly (5 feet long)	1
308730-A	Hydraulic Coupler	1

PARTS LIST - High-Pressure Pump Mechanism for Model 7531-B4 (Figure 4)

Part No.	Description	Qty.
● 45569	Hex Nut, 10-32	1
● 53776	Aluminum Gasket, 49/64" I.D. x 15/16" O.D.	1
● 171000-12	"O" Ring, 5/8" I.D. x 13/16" O.D.	1
● 171017-12	Back-up Ring, 13/16" O.D.	1
● 317201	Cup	1
● 317202	Rod	1
● 317203	Valve	1
317204-5	Plunger, 11-9/16" long	1
317205-5	Stop Bar, 10-5/16" long	1
317206-5	Tube Assembly, 12-3/8" long	1
317209	Sleeve	1
317210	Check-Valve Assembly	1
+ 328233	High-Pressure Body Assembly	1
+ 328236	Bushing	1
● 328237	Aluminum Gasket, 1/2" I.D. x 15/16" O.D.	1
+ 338389	Stud, 1-3/8" long	1

- Repair Kit Part
- + Not available as a separate purchased part

NOTE: The parts listed in this instruction sheet are for reference identification in the instructions and illustrations. Some of them are not available as separate parts and these are noted in the parts list. Standard items such as nuts, bolts, etc. should be purchased at a hardware store. Refer to the current parts price list and bulletins before ordering parts, and always give the part number, quantity, description and model where used when ordering parts. Parts availability and prices are subject to change without notice.

PARTS CHANGES SINCE LAST PRINTING

Initial Release